

INSTRUCTION SHEET

OFF VEHICLE CARBURETOR SERVICE

ROCHESTER MODEL—E4MC, E4ME

GENERAL EXPLODED VIEW

THE GENERAL DESIGN AND PARTS SHOWN WILL VARY TO INDIVIDUAL UNITS COVERED ON THIS INSTRUCTION SHEET.

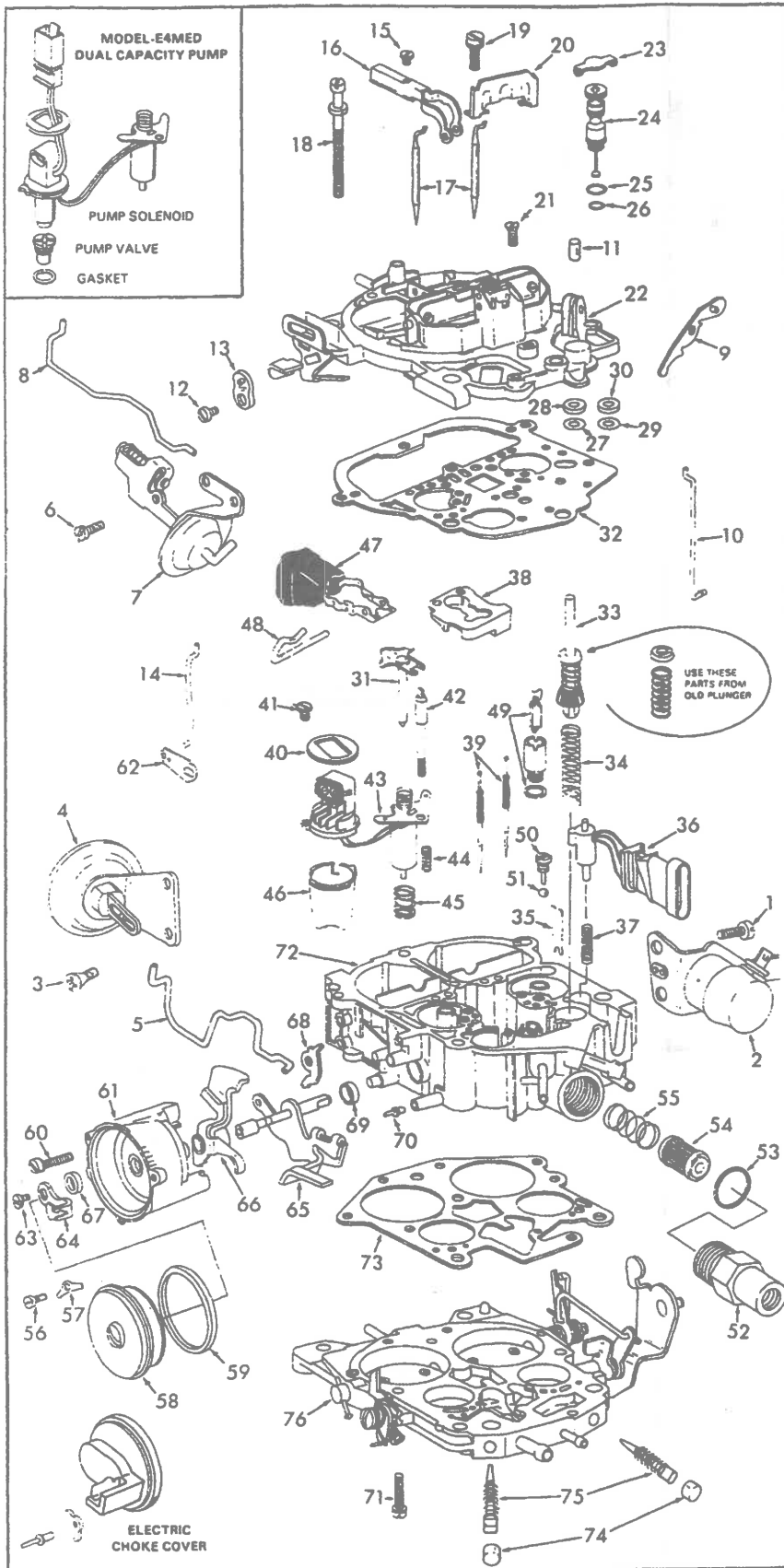

DISASSEMBLY

USE EXPLODED VIEW AS A GUIDE. THE NUMERICAL SEQUENCE MAY GENERALLY BE FOLLOWED TO DISASSEMBLE UNIT FAR ENOUGH TO PERMIT CLEANING AND INSPECTION. NOTE: TO REMOVE LEVER (9) JUST DRIVE PIN IN FAR ENOUGH TO RELEASE LEVER BOWL COVER SCREWS (21) ARE INSIDE THE AIR HORN. DO NOT REMOVE BRASS TUBES FROM BOWL COVER. COVER (23) HELD IN BY RIVETS. DRILL OUT RIVET HEADS DISCARD COVER (NOT REPLACED) BEFORE REMOVING IDLE AIR BLEED VALVE (24) TURN IN COUNTING THE NUMBER OF TURNS IT TAKES TO SEAT VALVE RECORD FOR PROPER REASSEMBLY MAIN JETS CAN BE REMOVED WITH PROPER WRENCH CHOKE COVER HELD ON BY POP RIVETS SEE FIG. 1 FOR REMOVAL PROCEDURE. IDLE NEEDLE PLUG (74) REMOVAL SEE FIG. 2. BEFORE REMOVING IDLE ADJUSTING NEEDLES (75), TURN IN COUNTING THE NUMBER OF TURNS IT TAKES TO SEAT NEEDLE RECORD FOR REASSEMBLY

NOMENCLATURE

REF. NO.	REF. NO.
1. SCREW (2) - SOLENOID	40. GASKET - ECM CONNECTOR TO BOWL COVER
2. SOLENOID - IDLE SPEED	41. SCREW - ECM CONNECTOR
3. SCREW (2) - REAR VAC. BREAK	42. SCREW - LEAN MIXTURE (SOL. ADJ.)
4. REAR VAC. BREAK	43. SOLENOID & ECM CONNECTOR ASSY
5. CONNECTING ROD - REAR VAC. BREAK	44. SPRING - LEAN MIXTURE SCREW
6. SCREW (2) - FRONT VAC. BREAK	45. SPRING - SOLENOID
7. FRONT VAC. BREAK & HOSE ASSY	46. INSERT - WELL
8. CONNECTING ROD - FRONT VAC. BREAK	47. FLOAT & LEVER ASSY
9. LEVER - PUMP	48. HINGE PIN - FLOAT
10. ROD - PUMP	49. NEEDLE & SEAT ASSY
11. PLUNGER - ACTUATOR	50. PLUG - PUMP DISC. BALL
12. SCREW - CHOKE LEVER	51. BALL - PUMP DISC
13. LEVER - CHOKE SHAFT	52. FILTER NUT - FUEL INLET
14. ROD - CHOKE	53. GASKET - FILTER NUT
15. SCREW - SEC. METERING ROD HOLDER	54. FILTER - FUEL
16. HOLDER - SEC. METERING RODS	55. SPRING - FILTER
17. METERING ROD (2) - SECONDARY	56. RIVET (3) - RETAINER (REPLACE WITH SCREWS)
18. SCREW & LKWSHR. (2) - BOWL COVER (LONG)	57. RETAINER (3) - CHOKE COVER
19. SCREW & LKWSHR. (3) - BOWL COVER	58. CHOKE COVER ASSY
20. BAFFLE - AIR	59. GASKET - CHOKE COVER (NOT USED ON ELECTRIC CHOKE)
21. SCREW (2) - BOWL COVER (TAPERED HEAD)	60. SCREW & WASHER - CHOKE HOUSING
22. BOWL COVER ASSY	61. CHOKE HOUSING ASSY
23. COVER - AIR BLEED VALVE (NOT USED OVER)	62. LEVER - INTERMEDIATE CHOKE
24. VALVE - IDLE AIR BLEED	63. SCREW - STAT COIL LEVER
25. O-RING - UPPER VALVE	64. LEVER - STAT COIL
26. O-RING - LOWER VALVE	65. SHAFT ASSY - INTERMEDIATE CHOKE
27. RETAINER - PUMP STEM SEAL	66. CAM - FAST IDLE
28. SEAL - PUMP STEM	67. SEAL - CHOKE HOUSING (SOME MODELS)
29. RETAINER - TPS PLUNGER SEAL	68. CAM - SECONDARY LOCKOUT
30. SEAL - TPS PLUNGER	69. SEAL - INTERMEDIATE CHOKE SHAFT
31. PLUNGER - SOLENOID	70. TUBE - VACUUM PASSAGE (SOME MODELS)
32. GASKET - BOWL COVER	71. SCREW & LKWSHR. (3) - THROTTLE BODY
33. PUMP PLUNGER ASSY.	72. FLOAT BOWL ASSY
34. SPRING - PUMP	73. GASKET - THROTTLE BODY
35. BAFFLE - PUMP WELL	74. PLUG (2) - IDLE NEEDLE (NOT REPLACED)
36. THROTTLE POSITION SENSOR ASSY	75. NEEDLE & SPRING ASSY (2) - IDLE ADJ
37. SPRING - TPS	76. THROTTLE BODY ASSY
38. INSERT - FLOAT BOWL	
39. MAIN METERING ROD & SPRING ASSY (2)	

CLEANING

CLEANING MUST BE DONE WITH CARBURETOR DISASSEMBLED. SOAK PARTS LONG ENOUGH TO SOFTEN AND REMOVE ALL FOREIGN MATERIAL. USE A CARBURETOR CLEANING SOLVENT. MAKE CERTAIN THE THROTTLE BORES ARE FREE OF ALL CARBON DEPOSITS. RINSE OFF IN SUITABLE SOLVENT BLOW OUT ALL PASSAGES IN CASTINGS WITH COMPRESSED AIR AND CHECK CAREFULLY TO INSURE THOROUGH CLEANING OF OBSCURE AREAS. CAUTION: DO NOT SOAK DIAPHRAGM UNITS, SOLENOIDS, FLOAT, ELECTRIC CHOKE OR PARTS CONTAINING RUBBER OR PLASTIC IN CLEANING SOLVENTS.

REASSEMBLY

REASSEMBLE IN REVERSE ORDER OF DISASSEMBLY. NOTE SPECIAL INSTRUCTIONS AND FOLLOW NUMERICAL OUTLINE IN MAKING ADJUSTMENTS

SPECIAL INSTRUCTIONS

IDLE ADJUSTING NEEDLES (75) - TURN EACH NEEDLE IN UNTIL LIGHTLY SEATED. THEN BACK OUT NUMBER OF TURNS RECORDED ON DISASSEMBLY (BASIC SETTING 4 1/2 TURNS OUT).

SEALS INTERMEDIATE CHOKE SHAFT (69), (67) - SEAL (69) INSTALL WITH LIP FACING OUT SEAL (67) INSTALL WITH LIP FACING IN

ELECTRIC CHOKE MODELS DO NOT USE A CHOKE COVER GASKET (59)

FUEL FILTER (54) - BE SURE TO USE FILTER WITH BUILT IN ROLL OVER CHECK VALVE AND WITH CHECK VALVE FACING OUT TIGHTEN FILTER NUT TO 18 FT LBS

FLOAT INSTALLATION - INSTALL FLOAT BY SLIDING FLOAT LEVER UNDER PULL CLIP FROM FRONT TO BACK. INSTALL FLOAT PIN (DO NOT INSTALL PULL CLIP IN HOLES OF FLOAT ARM)

LEAN MIXTURE SCREW (42) - (SOLENOID ADJ.) - TURN MIXTURE CONTROL SCREW IN FLOAT BOWL CLOCKWISE UNTIL LIGHTLY BOTTOMED THEN BACK OUT 3 1/2 TURNS

IDLE AIR BLEED VALVE (24) - TURN VALVE IN UNTIL LIGHTLY BOTTOMED THEN BACK OUT 17 NUMBER OF TURNS RECORDED ON DISASSEMBLY (IF NOT KNOWN BACK OUT 4 TU)

SEALS (30) (28) - INSTALL WITH LIP OF SEAL FACING UPWARD LIGHTLY STAKE RETAINER IN THREE PLACES.

THE COMPUTER COMMAND CONTROL (CCC) FORMERLY (C4) SYSTEM IS A SOPHISTICATED SYSTEM. THE PROCEDURE FOR SETTING THE IDLE AIR BLEED VALVE AND MIXTURE CONTROL SYSTEM MUST BE FOLLOWED EXACTLY USE THE ENGINE DECAL AND CAR DIV SERVICE MANUAL PROCEDURE

ADJUSTMENTS

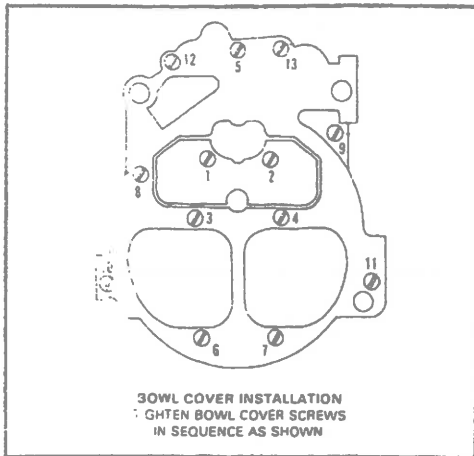

BOWL COVER INSTALLATION
TIGHTEN BOWL COVER SCREWS
IN SEQUENCE AS SHOWN

CAREFULLY ALIGN A #21 DRILL (159") ON POP RIVET HEAD AND DRILL ENOUGH TO REMOVE RIVET HEAD. DRILL ALL 3 RIVET HEADS. USE A DRIFT PUNCH AND HAMMER, DRIVE THE REMAINDER OF RIVETS OUT OF THE CHOKE HOUSING. REMOVE CHOKE COMPONENTS. REPLACEMENT RETAINERS, SELF TAPPING SCREWS OR POP RIVETS ARE FOUND IN REPAIR KIT

BEFORE ASSEMBLING CHOKE, START SELF TAPPING SCREWS IN CHOKE HOUSING TO BE SURE SCREWS START EASILY AND ARE ALIGNED PROPERLY CHOKE COVER INSTALLATION, ALIGN NOTCH IN COVER WITH RETAINER TAB (2 O'CLOCK POSITION) TIGHTEN SCREWS EVENLY AND SECURELY. 1981 INSTALL RETAINERS AND NEW POP RIVETS TO SECURE CHOKE COVER.

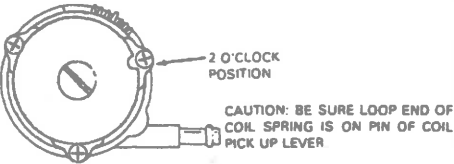

REMOVING & REPLACING TAMPER RESISTANT CHOKE COVER
FIG. 1

SAW 2 SLOTS AS SHOWN (DO NOT EXTEND MORE THAN 1/8" BEYOND LOCATOR POINTS). SUPPORT THROTTLE BODY, THEN PLACE A PUNCH BETWEEN THE TWO LOCATOR POINTS IN THROTTLE BODY HOLDING PUNCH AT 45° ANGLE BREAK OUT THROTTLE BODY CASTING TO GAIN ACCESS TO THE HARDENED STEEL PLUG HOLD A CENTER PUNCH VERTICAL DRIVE IT INTO THE STEEL PLUG (HARDENED PLUG WILL BREAK). REMOVE PIECES TO GAIN ACCESS TO IDLE MIXTURE NEEDLE

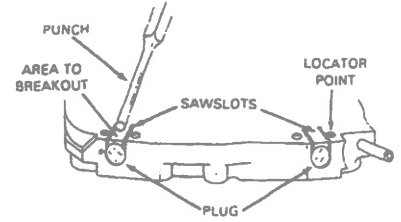

IDLE MIXTURE NEEDLE PLUG REMOVAL
FIG. 2

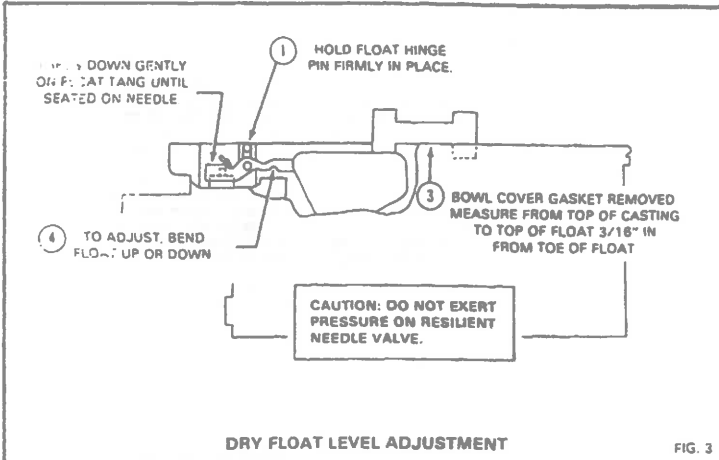

DRY FLOAT LEVEL ADJUSTMENT
FIG. 3

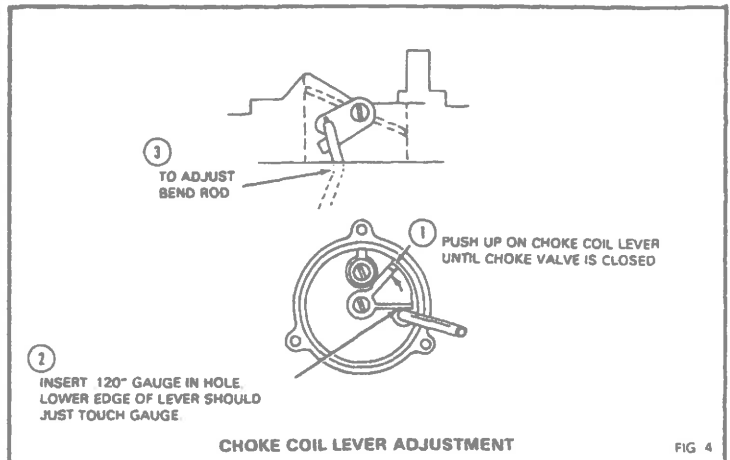

CHOKE COIL LEVER ADJUSTMENT
FIG. 4

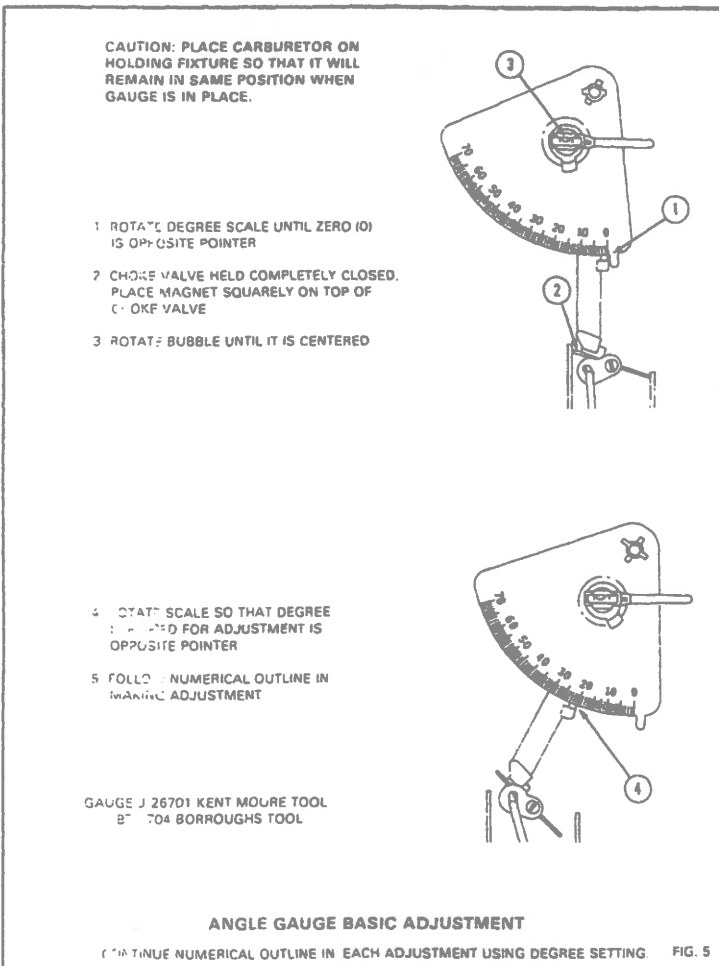

ANGLE GAUGE BASIC ADJUSTMENT
CONTINUE NUMERICAL OUTLINE IN EACH ADJUSTMENT USING DEGREE SETTING
FIG. 5

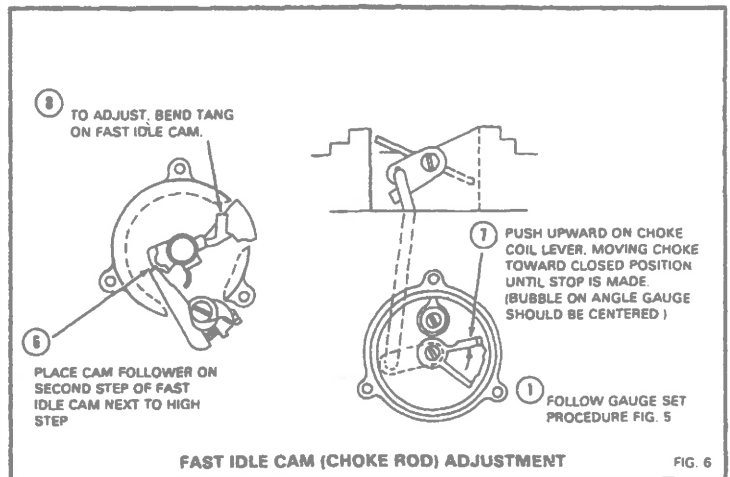

FAST IDLE CAM (CHOKE ROD) ADJUSTMENT
FIG. 6

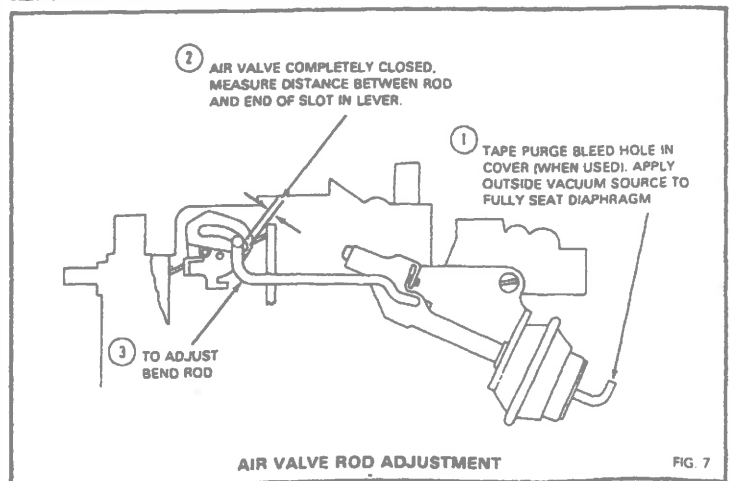

AIR VALVE ROD ADJUSTMENT
FIG. 7

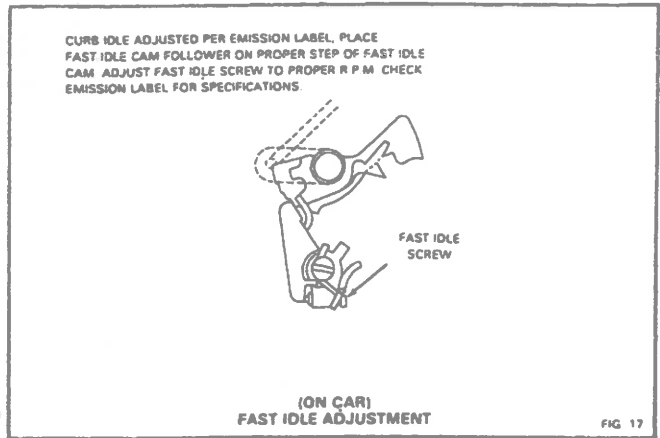
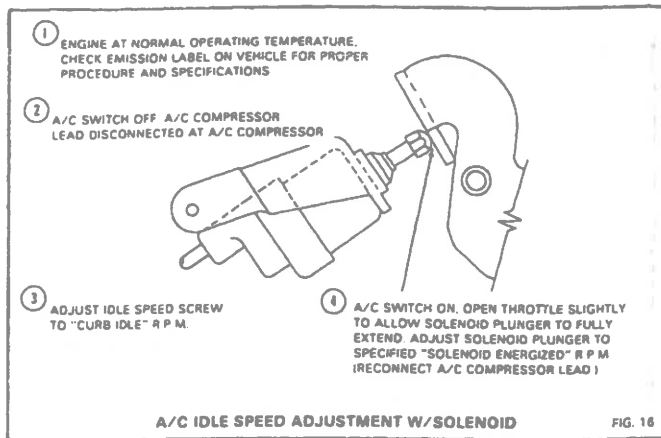

ADJUSTMENT DATA TABLE

YEAR	APPLICATION	FLOAT LEVEL	FAST IDLE CAM (CHOKE ROD)	VACUUM BREAK FRONT	VACUUM BREAK REAR	AIR VALVE SPRING (TURNS)	UNLOADER SETTING	
1980	BUICK V6 231" ENG							
	CARB NO 17080540, 0543	3/8"	14 5°	19°	23°	9/16	38°	
	CARB NO 17080542	3/8"	14 5°	19°	13°	9/16	38°	
	CARB NO 17080545	3/8"	14 5°	19°	18°	9/16	38°	
	BUICK V8 305" ENG							
	CARB NO 17080502, 504 516 517	1/2"	20°	24°	30°	7/8	38°	
	BUICK V8 350" ENG							
	CARB NO 17080553 554	15/32"	17°	25°	35°	1/2	35°	
	1981	BUICK V6 231" ENG						
		CARB NO 17081242	5/16"	24 5°	17°	15°	9/16	38°
CARB NO 17081243		1/4"	24 5°	19°	17°	9/16	38°	
BUICK V6 252" ENG								
CARB NO 17081245, 1247 1248 1249		3/8"	24 5°	28°	24°	5/8	38°	
CARB NO 17081289		13/32"	24 5°	28°	24°	5/8	38°	
BUICK V8 307" ENG								
CARB NO 17081253 1254		15/32"	14°	25°	36°	1/2	35°	
1982		BUICK V6 231" ENG						
		CARB NO 17082244	9/32"	24 5°	21°	16°	9/16	32°
	CARB NO 17082249	9/32"	24 5°	20°	15°	9/16	38°	
	BUICK V6 252" ENG							
	CARB NO 17082245, 2246	3/8"	24 5°	26°	26°	5/8	32°	
	CARB NO 17082247, 2248	3/8"	18°	26°	26°	5/8	32°	
	BUICK V8 307" ENG	7/16"	14°	27°	41°	1/2	35°	
	1980	CADILLAC V8 368" ENG						
		CARB NO 17080530*	17/32"	16°	25°	47°	1/2	40°
		1981	CADILLAC V6 252" ENG					
CARB NO 17081248			3/8"	24 5°	28°	24°	5/8	38°
CARB NO 17081289		13/32"	24 5°	28°	24°	5/8	38°	
1982		CADILLAC V6 252" ENG						
	CARB NO 17082246	3/8"	24 5°	26°	26°	5/8	32°	
CARB NO 17082247	3/8"	18°	26°	26°	5/8	32°		
1980	CHEVROLET V6 231" ENG							
	CARB NO 17080543	3/8"	14 5°	19°	23°	9/16	38°	
	CHEVROLET V8 305" ENG							
	CARB NO 17080502, 504	1/2"	20°	24°	30°	7/8	38°	
	1981	CHEVROLET V6 231" ENG						
		CARB NO 17081202, 1203 1204 1207	1/4"	24 5°	19°	17°	9/16	38°
	CHEVROLET V8 305" ENG							
	CARB NO 17081202, 1203 1204 1207	11/32"	20°	26°	...	7/8	38°	
	CHEVROLET V8 350" ENG							
	CARB NO 170801216, 1217 1218	11/32"	20°	26°	...	7/8	38°	
1982	CHEVROLET V8 305" ENG							
	CARB NO 170801216, 1217 1218	11/32"	20°	27°	--	7/8	38°	
1980	OLDSMOBILE V8 305" ENG							
	CARB NO 17080504 517	1/2"	20°	24°	30°	7/8	38°	
	OLDSMOBILE V8 350" ENG							
	CARB NO 17080553, 554	15/32"	17°	25°	35°	1/2	35°	
	1981	OLDSMOBILE V6 252" ENG						
		CARB NO 17081248	3/8"	24 5°	28°	24°	5/8	38°
	CARB NO 17081289	13/32"	24 5°	28°	24°	5/8	38°	
	OLDSMOBILE V8 307" ENG							
	CARB NO 17081253, 1254	15/32"	14°	25°	36°	1/2	35°	
	1982	OLDSMOBILE V6 252" ENG						
CARB NO 17082246		3/8"	24 5°	26°	26°	5/8	32°	
CARB NO 17082247		3/8"	18°	26°	26°	5/8	32°	
OLDSMOBILE V8 307" ENG		7/16"	14°	27°	41°	1/2	35°	
1980	PONTIAC V8 305" ENG							
	CARB NO 17080504 517	1/2"	20°	24°	30°	7/8	38°	
	PONTIAC V8 350" ENG							
	CARB NO 17080553	15/32"	17°	25°	35°	1/2	35°	
	1981	PONTIAC V8 301" ENG						
		CARB NO 17081270	7/16"	14 5°	24°	34°	5/8	35°
		CARB NO 17081272	7/16"	14 5°	24°	40°	5/8	35°
		CARB NO 17081273 1274	7/16"	16°	24°	34°	5/8	35°
	PONTIAC V8 305" ENG							
	CARB NO 17081203, 1207	11/32"	20°	26°		7/8	38°	
PONTIAC V8 307" ENG								
CARB NO 17081254	15/32"	14°	25°	36°	1/2	35°		
1982	PONTIAC V6 252" ENG							
	CARB NO 17082202, 2204	3/8"	18°	26°	26°	5/8	32°	
	PONTIAC V8 305" ENG							
CARB NO 17082202, 2204	11/32"	20°	27°	--	7/8	38°		
CARB NO 17082203 2207	11/32"	38°	27°	--	7/8	38°		

*PUMP ROD LOCATION INNER HOLE OF PUMP LEVER

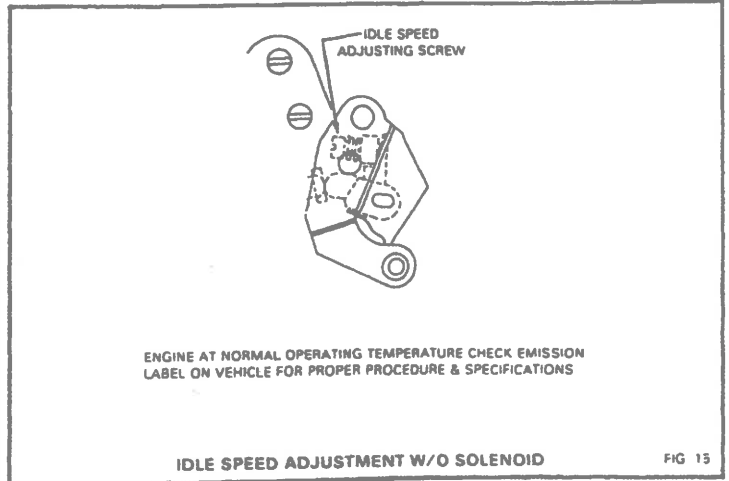
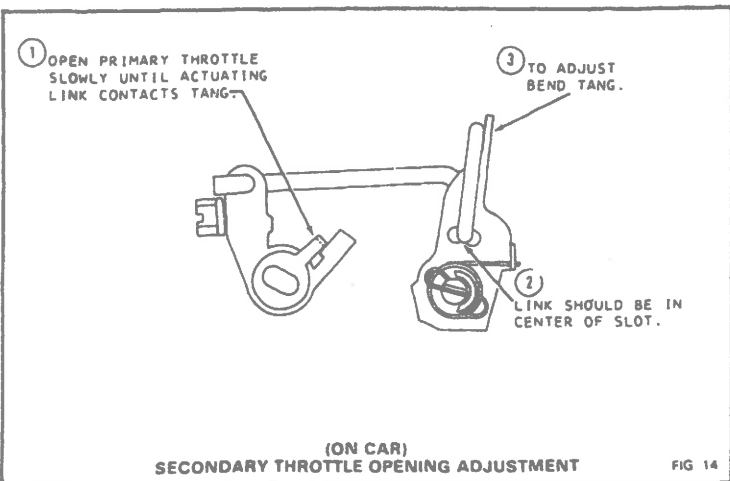
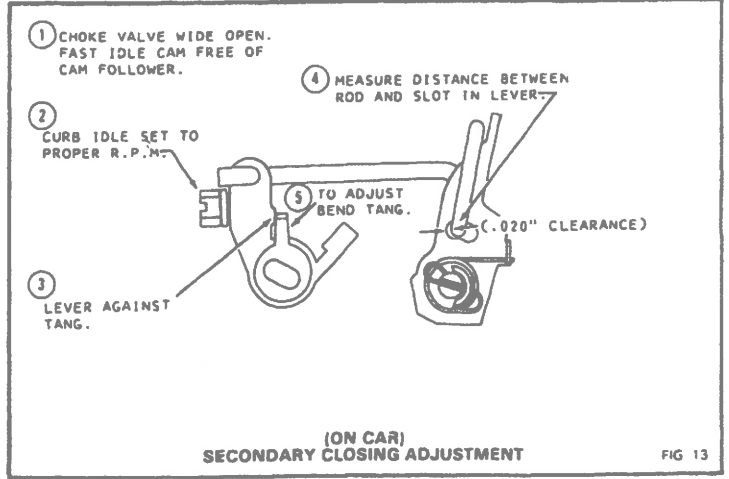
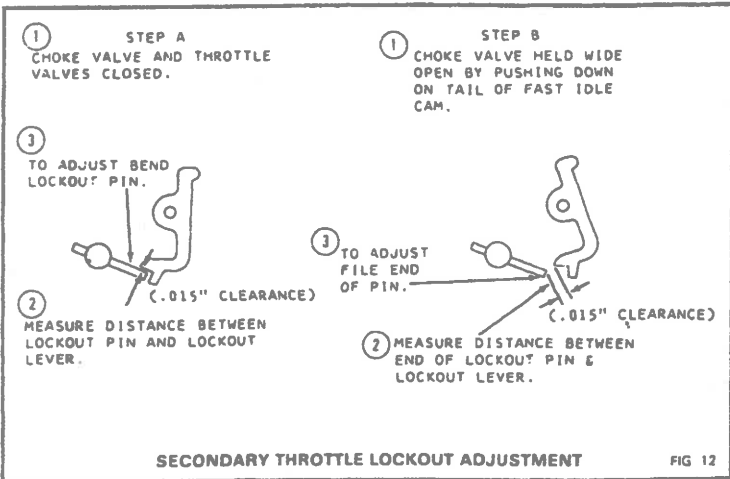
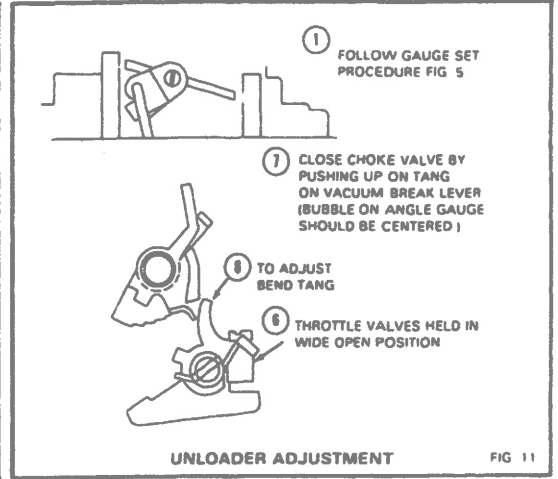
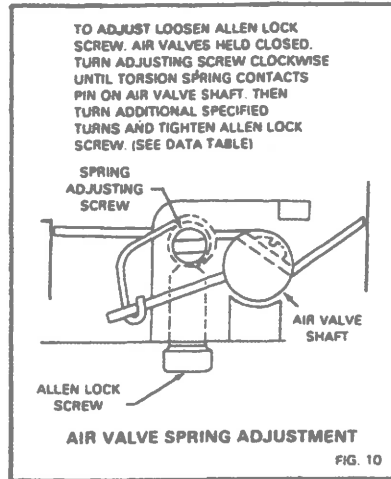
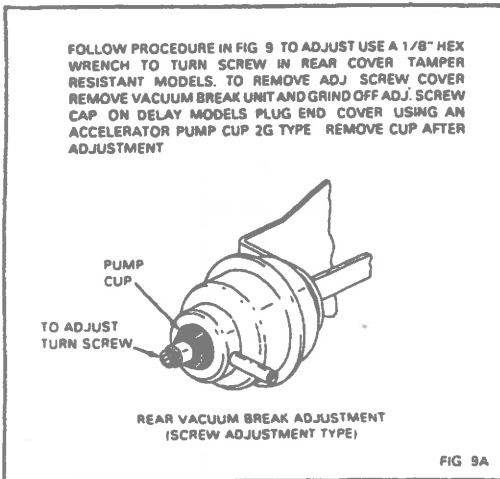
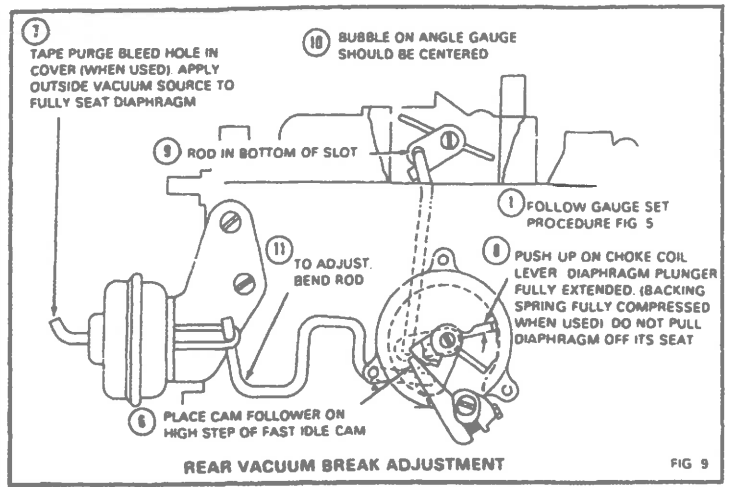
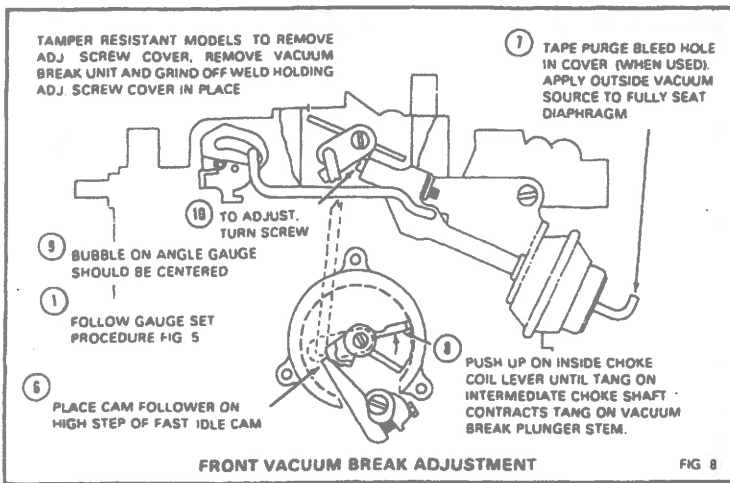

USE WITH GF10407
ADJUSTMENT DATA TABLE ROCHESTER MODELS - E4MC, E4ME, E4MED

YEAR	APPLICATION	FLOAT LEVEL	FAST IDLE CAM CHOKE ROD	VACUUM BREAK FRONT	VACUUM BREAK REAR	AIR VALVE SPRING (TURNS)	UNLOADER SETTING	
BUICK								
1980	231" ENG. V6							
	CARB #17080540, 543	3/8"	14.5°	19°	23°	9/16	38°	
	CARB #17080542	3/8"	14.5°	19°	13°	9/16	38°	
	CARB #17080545	3/8"	14.5°	19°	18°	9/16	38°	
	305" ENG. V8							
1981	CARB #17080502, 504, 516, 517	1/2"	20°	24°	30°	7/8	38°	
	350" ENG. V8							
	CARB #17080553, 554	15/32"	17°	25°	35°	1/2	35°	
1982	231" ENG. V6							
	CARB #17081242	5/16"	24.5°	17°	15°	9/16	38°	
	CARB #17081243	1/4"	24.5°	19°	17°	9/16	38°	
	252" ENG. V6							
	CARB #17081245, 247, 248, 249	3/8"	24.5°	28°	24°	5/8	38°	
1982-83	CARB #17081289	13/32"	24.5°	28°	24°	5/8	38°	
	307" ENG. V8							
	CARB #17081253, 254	15/32"	14°	25°	36°	1/2	35°	
	231" ENG. V6							
	CARB #17082244, 260	9/32"	24.5°	21°	16°	9/16	32°	
1983	CARB #17082249	9/32"	24.5°	20°	15°	9/16	38°	
	252" ENG. V6							
	CARB #17082265, 266	3/8"	24.5°	26°	26°	5/8	32°	
	CARB #17082267, 268	3/8"	18°	26°	26°	5/8	32°	
	307" ENG. V8	7/16"	14°	27°	41°	1/2	35°	
1984	231" ENG. V6							
	CARB #17083242	9/32"	24.5°	20°	---	9/16	38°	
	CARB #17083244	1/4"	24.5°	21°	16°	9/16	32°	
	252" ENG. V6							
	CARB #17082245, 246, 294, 295, 17083248	3/8"	24.5°	26°	28°	5/8	32°	
1985-90	CARB #17082247, 248, 298, 299	3/8"	18°	26°	26°	5/8	32°	
	252" ENG. V6 (4.1L)							
	CARB #17084240, 244	5/16"	24.5°	24°	---	1	32°	
	CARB #17084246	5/16"	24.5°	22°	24°	1	32°	
	307" ENG. V8 (5.0L)							
1986	CARB #17084252, 254	7/16"	14°	27°	41°	1/2	35°	
	CARB #17084256, 258	11/32"	14°	25°	41°	1/2	35°	
	307" ENG. V8 (5.0L)							
	CARB #17085282, 17086008, 17088115	11/32"	14°	25°	43°	1/2	35°	
	305" ENG. V8 (5.0L)							
1988	CARB #17086004	11/32"	20°	27°	---	7/8	38°	
	CADILLAC							
	1980	368" ENG. V8						
		CARB #17080530*	17/32"	16°	25°	47°	1/2	40°
	1981	252" ENG. V6						
CARB #17081248		3/8"	24.5°	28°	24°	5/8	38°	
1982-83	CARB #17081289	13/32"	24.5°	28°	24°	5/8	38°	
	252" ENG. V6							
	CARB #17082246, 266, 285	3/8"	24.5°	26°	26°	5/8	32°	
	CARB #17082247, 267, 298	3/8"	18°	26°	26°	5/8	32°	
	307" ENG. V8 (5.0L)							
1988-90	CARB #17086008, 17088115	11/32"	14°	25°	43°	1/2	35°	
	CHECKER MOTORS							
1980	305" ENG. CALIF	1/2"	20°	24°	30°	7/8	38°	
	305" ENG.	11/32"	20°	26°	---	7/8	38°	
	305" ENG.	11/32"	20°	27°	---	7/8	38°	
CHEVROLET								
1980	231" ENG. V6							
	CARB #17080543	3/8"	14.5°	19°	23°	9/16	38°	
	305" ENG. V8							
1981	CARB #17080502, 504, 516, 517	1/2"	20°	24°	30°	7/8	38°	
	231" ENG. V6	1/4"	24.5°	19°	17°	9/16	38°	
	305" ENG. V8							
	CARB #17081202, 203, 204, 207	11/32"	20°	26°	---	7/8	38°	
	CARB #17081219, 222	11/32"	20°	28°	---	7/8	38°	
1982-83	350" ENG. V8							
	CARB #17081216, 217, 218	11/32"	20°	26°	---	7/8	38°	
	CARB #17081224, 228	11/32"	20°	28°	---	7/8	38°	
	305" ENG. V8							
	CARB #17082202, 204	11/32"	20°	27°	---	7/8	38°	
1983	350" ENG. V8							
	CARB #17082216, 218	11/32"	20°	27°	---	7/8	38°	
	305" ENG. V8							
1984	CARB #17082203, 17083207	11/32"	38°	27°	---	7/8	38°	
	CARB #17083204	11/32"	20°	27°	---	7/8	38°	
	305" ENG. V8 (5.0L)							
1984	CARB #17084201, 208	11/32"	20°	27°	---	7/8	38°	
	CARB #17084205, 209	11/32"	38°	27°	---	7/8	38°	

*Pump Rod Location: Inner Hole of Pump Lever

Note 1: 2 STEP CAM (STAMPED AD) - 38°
3 STEP CAM (STAMPED E) - 20°

YEAR	APPLICATION	FLOAT LEVEL	FAST IDLE CAM CHOKE ROD	VACUUM BREAK FRONT	VACUUM BREAK REAR	AIR VALVE SPRING (TURNS)	UNLOADER SETTING
CHEVROLET (Cont'd)							
1985	305" ENG. V8 (5.0L) CARB #17085202, 204	11/32"	20°	27°	---	7/8	38°
	CARB #17085203	11/32"	NOTE: 1	27°	---	7/8	38°
	CARB #17085207	11/32"	38°	27°	---	7/8	38°
	350" ENG. V8 (5.7L) CARB #17085218	11/32"	20°	27°	---	7/8	38°
1986-87	305" ENG. V8 (5.0L) CARB #17086005, 040	11/32"	38°	27°	---	7/8	38°
	305" (5.0L), 350" (5.7L) V8 ENG. CARB #17086003, 004, 006	11/32"	20°	27°	---	7/8	38°
1986-90	307" ENG. V8 (5.0L) CARB #17086008, 17088115	11/32"	14°	25°	43°	1/2	35°
1988-89	305" (5.0L), 350" (5.7L) V8 ENG. CARB #17087129, 132, 306, 17088152	11/32"	20°	27°	---	7/8	38°
CHEVROLET/GMC TRUCK							
1983	305" (5.0L), 350" (5.7L) ENG. CALIF. CARB #17083506, 508, 524, 526	7/16"	20°	27°	36°	7/8	36°
1984	305" ENG. V8 (5.0L)	7/16"	20°	25°	36°	1	36°
	350" ENG. V8 (5.7L)	7/16"	20°	27°	36°	1	36°
1985	261" ENG. V8 (4.3L) CARB #17085502, 503	7/16"	20°	26°	36°	7/8	39°
1985-86	305" ENG. V8 (5.0L) CARB #17085524, 526	7/16"	20°	25°	36°	1	36°
	350" ENG. V8 (5.7L) CARB #17085506, 508	7/16"	20°	27°	36°	1	36°
1986	265" ENG. V6 (4.3L) CARB #17086057, 058	9/16"	20°	26°	36°	7/8	39°
CHRYSLER PRODUCTS							
1985-89	318" ENG. V8 (5.2L) CARB #17085407, 433	7/16"	20°	25°	---	7/8	30°
OLDSMOBILE							
1980	305" ENG. V8 CARB #17080504, 517	1/2"	20°	24°	30°	7/8	38°
	350" ENG. V8 CARB #17080553, 554	15/32"	17°	25°	35°	1/2	35°
1981	252" ENG. V6 CARB #17081248	3/8"	24.5°	28°	24°	5/8	38°
	CARB #17081289	13/32"	24.5°	28°	24°	5/8	38°
	307" ENG. V8 CARB #17081253, 254	15/32"	14°	25°	36°	1/2	35°
1982-83	252" ENG. V6 CARB #17082246, 266, 295	3/8"	24.5°	26°	26°	5/8	32°
	CARB #17082247, 267, 298	3/8"	18°	26°	26°	5/8	32°
	307" ENG. V8	7/16"	14°	27°	41°	1/2	35°
1984	252" ENG. V6 (4.1L) CARB #17084246	5/16"	24.5°	22°	24°	1	32°
	307" ENG. V8 (5.0L) CARB #17084252, 254	7/16"	14°	27°	41°	1/2	35°
	CARB #17084256, 258	11/32"	14°	25°	41°	1/2	35°
1985	307" ENG. V8 (5.0L) CARB #17085282	11/32"	14°	25°	43°	1/2	35°
	CARB #17085554	7/16"	14°	27°	41°	1/2	35°
1986-90	307" ENG. V8 (5.0L) CARB #17086008, 17088115	11/32"	14°	25°	43°	1/2	35°
	CARB #17086009	7/16"	14°	25°	43°	1/2	35°
PONTIAC							
1980	305" ENG. V8 CARB #17080504, 517	1/2"	20°	24°	30°	7/8	38°
	350" ENG. V8 CARB #17080553	15/32"	17°	25°	35°	1/2	35°
1981	301" ENG. V8 CARB #17081270	7/16"	14.5°	24°	34°	5/8	35°
	CARB #17081272	7/16"	14.5°	24°	40°	5/8	35°
	CARB #17081273, 274	7/16"	16°	24°	34°	5/8	35°
	305" ENG. V8 CARB #17081203, 207	11/32"	20°	26°	---	7/8	38°
	307" ENG. V8 CARB #17081254	15/32"	14°	25°	36°	1/2	35°
1982	252" ENG. V8 CARB #17082268	3/8"	18°	26°	26°	5/8	32°
	CARB #17082299	9/32"	24.5°	20°	15°	9/16	38°
1982-89	305" ENG. V8 (5.0L) CARB #17082202, 204, 17083204	11/32"	20°	27°	---	7/8	38°
	17084201, 208, 17085204						
	17086004						
	CARB #17082203, 207, 17083207						
	17084205, 209, 17085207						
	17086005, 040	11/32"	38°	27°	---	7/8	38°
1985	305" ENG. V8 (5.0L) CARB #17085203	11/32"	Note: 1	27°	---	7/8	38°
1986-89	307" ENG. V8 (5.0L) CARB #17086008, 17088115	11/32"	14°	25°	43°	1/2	35°

*Pump Rod Location: Inner Hole of Pump Lever

Note 1: 2 STEP CAM (STAMPED AD) - 38°
3 STEP CAM (STAMPED E) - 20°